

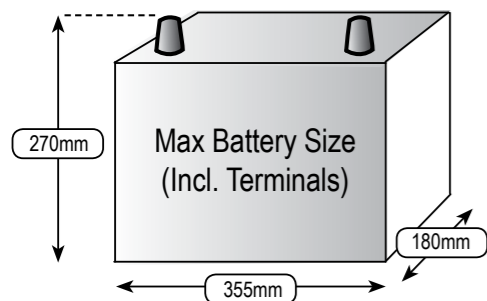

BLACK BOX (Standard)



BLUE BOX (Extra Height)



115 A/H AGM Battery

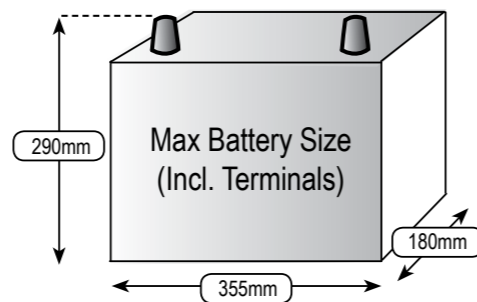

140 A/H AGM Battery



12V AUXILIARY BATTERY BOX

NATIONAL LUNA SALES AND SUPPORT

STREET ADDRESS

34 Plantation Road
Eastleigh, Edenvale
1609 Johannesburg
South Africa

POSTAL ADDRESS

PO Box 8899
Edenglen 1613
Johannesburg
South Africa

CONTACT

+27 (0)11 452-5438 (tel)
+27 (0)11 452-5263 (fax)
info@nationalluna.com
sales@nationalluna.com

The **Black** Auxiliary Battery Box has been designed to accommodate a maximum battery size of 355 (width) x 180 (depth) x 270 (height) mm.

The **Blue** Auxiliary Battery Box has been heightened to accommodate a maximum battery size of 355 (width) x 180 (depth) x 290 (height) mm.

Patent & design registrations: 2017/06341, F2017/01515, F2017/01516

WWW.NATIONALLUNA.COM

DESIGNED & MANUFACTURED BY NATIONAL LUNA IN SOUTH AFRICA

12V AUXILIARY BATTERY BOX

INSTALLATION OF 29mm ACCESSORIES

(Does not include a Battery Management/Split Charging System.)

The 12V Auxiliary Battery Box is a universal box that can be customized to suit the individual's needs.

FEATURES:

- Fused Outputs
- Simple Installation
- Built-in Battery Volt meter
- Compatible with most vehicles
- 4 x Spare pre-wired output ports
- Suitable for most automotive batteries
- Hi-powered 50Amp input & output ports

OPTIONAL EXTRAS:

- In-line Fuse holder
- Intelligent Solenoid
- DC to DC Converter
- NL5 Battery Charger
- Additional 29mm Sockets
- 7 meter 16mm² charge cable kit

INSTALLATION

Decide on the location of the 12V Auxiliary Battery Box. Ensure that there is enough clearance on the side of the Auxiliary Box to prevent plugs and cables from bumping or rubbing against nearby surfaces. Allow clearance for the main power cables to bend in the desired direction.

Route the input charge cable (not supplied in this kit) from the 12V Auxiliary Battery Box towards the main vehicle battery. (It is often best to follow existing wiring or brake lines.) Secure the cables and make sure that they are not exposed to physical movement or direct heat.

Connect the power cables to the terminals of the MAIN battery. It is recommended to install an in-line fuse as close to the main vehicle battery as possible.

Secure cables and double-check all connections.

Complete the installation by tightening the battery hold-down bracket and battery into the 12V Auxiliary Battery Box. Connect the Auxiliary Battery to the cables within the 12V Auxiliary Battery Box. (Check polarity - RED is POSITIVE, BLACK is NEGATIVE)

Plug the input power cable into the 12V Auxiliary Battery Box RED receptacle, ensuring good contact. The main power isolator switch can now be turned "ON".



- 4 x Spare Ports
- 2 x 50Amp Output
- 2 x 2.4A USB
- 50Amp Input
- NL5 Battery Charger Input
- Volt Meter
- Isolator Switch
- Cigar Female
- 4 x 15A Fuses
- Din/Hella Female

STEP 1

Start by removing the two screws on the front, followed by the one on the left hand side and then finally the two on the right hand side. Once all screws have been removed, pull the face plate forwards.



STEP 2

Unplug the main harness from the box for ease of installation. (Press down locking clip and slide out coupler.)

Note: The box has already been pre-wired to accommodate an additional 4 x 29mm fittings.

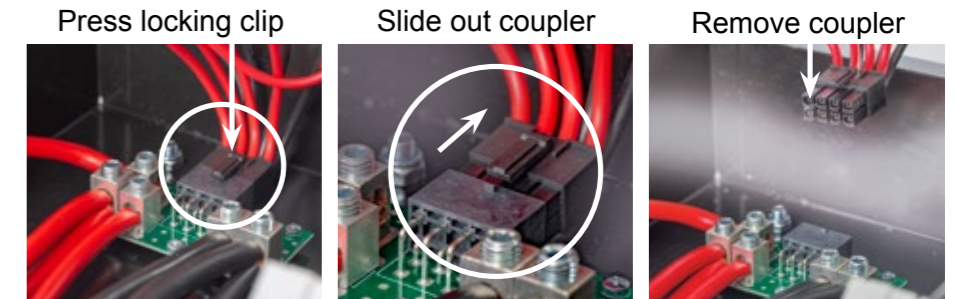

STEP 3

Remove the spare blank from the face plate and insert the required additional 29mm fitting. Secure the fitting by tightening the locking ring. Connect the red wire (+) and the black wire (-) to the back of the fitting.



STEP 4

Reconnect the main harness by re-inserting the coupler. Secure the face plate to the main box by replacing and tightening the screws on the front and the sides of the box.



ADDITIONAL 29mm PLUGS FOR SPARE PORTS

29mm PANEL MOUNT CIGAR



BSP-05001

29mm PANEL MOUNT USB 4.8A



BSP-05002

29mm PANEL MOUNT DIN/HELLA FEMALE



BSP-05202

29mm PANEL MOUNT VOLT & AMP METER



BSP-05103

29mm PANEL MOUNT ENGEL FEMALE



BSP-05003

Optional male plug

OPTIONAL ACCESSORIES

NL 5A BATTERY CHARGER



BMS-60050

INTELLIGENT SOLENOID



BMS-20001

DC-DC 25A CONVERTER



BMS-30250

7M BLACK & RED 16mm² CABLE KIT



WIR-57401

IN-LINE FUSE HOLDER



Fuses not included.

BSP-10103